

STA 2+430.00 LOOKING EAST

NOTE:
LOCATIONS ARE APPROXIMATE AND FURTHER INVESTIGATION TO
CONFIRM LOCATION MAYBE REQUIRED BY THE CONTRACTOR.

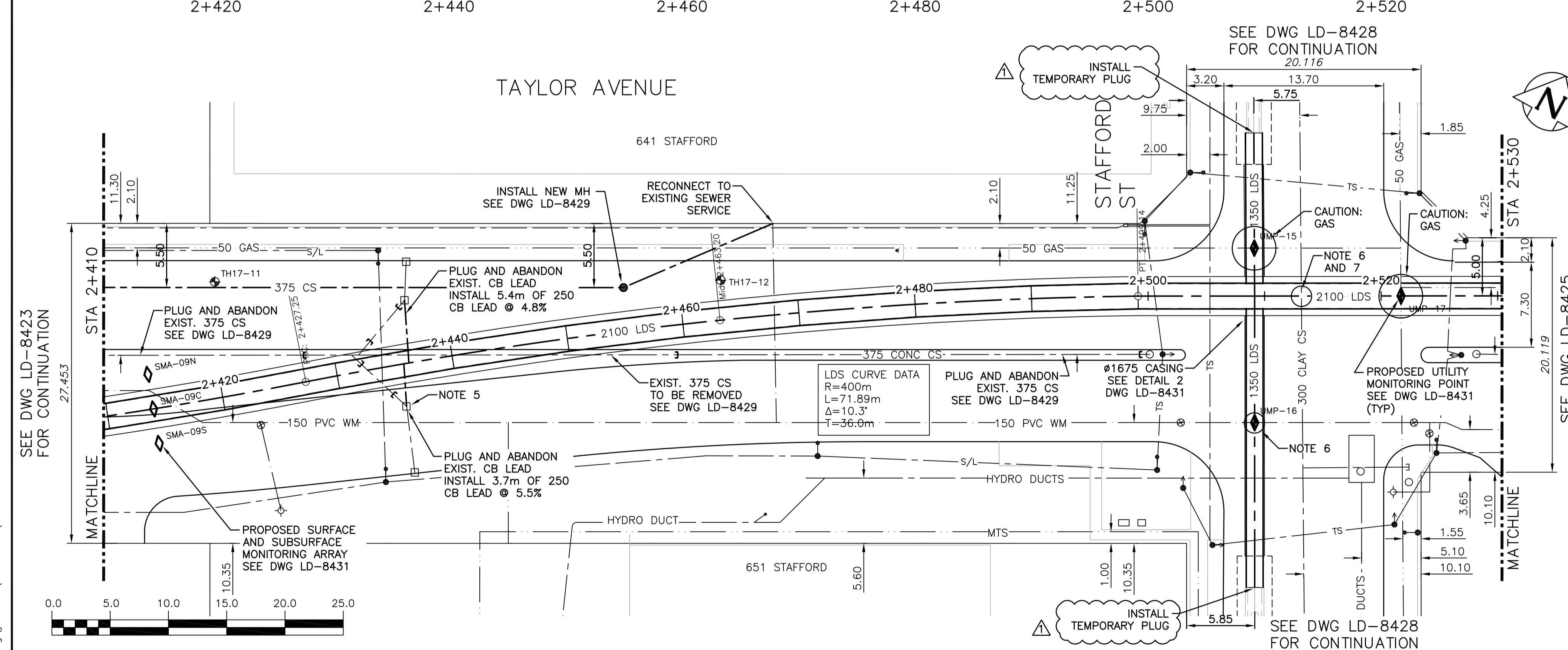

WARNING
IF POWER EQUIPMENT OR EXPLOSIVES ARE TO BE USED FOR EXCAVATION
ON THIS PROJECT THE CONTRACTOR MUST:
1) NOTIFY THE GAS COMPANY OF THE PROPOSED LOCATION OF EXCAVATION.
2) TAKE PRECAUTION TO AVOID DAMAGE TO GAS COMPANY INSTALLATIONS.
SEE PROVINCIAL REGULATION 210/72 FOR DETAILS

PROPERTY LIMITS DELINEATION
DELINEATION OF PROPERTY LIMITS AS SHOWN ON THIS
DRAWING DOES NOT REPRESENT A "LEGAL SURVEY".
CH2M HILL MAKES NO REPRESENTATION OR WARRANTY AS
TO THE ACCURACY OF PROPERTY LIMITS DELINEATED ON
THIS DRAWING, NOR ON THE DIMENSIONAL ACCURACY OF
DRAWING FEATURES RELATIVE TO THOSE PROPERTY LIMITS.

- CONSTRUCTION NOTES:**
- SEWER AND WATER SERVICES SHOWN ON DRAWING ARE APPROXIMATE ONLY.
 - LOCATION OF ALL SEWER AND WATER LINES TO BE CONFIRMED IN FIELD.
 - INSTALL NEW SEWER BY TRENCHLESS METHODS, UNLESS OTHERWISE NOTED.
 - TRAFFIC MANAGEMENT PLAN TO BE IMPLEMENTED AS PER SPECIFICATIONS DURING EACH PHASE OF CONTRACT.
 - REPLACE SOLID MANHOLE LID WITH SLOTTED LID.
 - HYDRO EXCAVATE UTILITY PRIOR TO TUNNEL CONSTRUCTION.
 - PRE AND POST CCTV OF UTILITY CROSSING.
 - LOCATE AND HYDRO EXCAVATE SEWER SERVICE(S) ALONG TAYLOR AVENUE FROM BUILDING AT 651 STAFFORD STREET.

APEGM
Certificate of Authorization
CH2M HILL Canada Ltd.
No. 1441

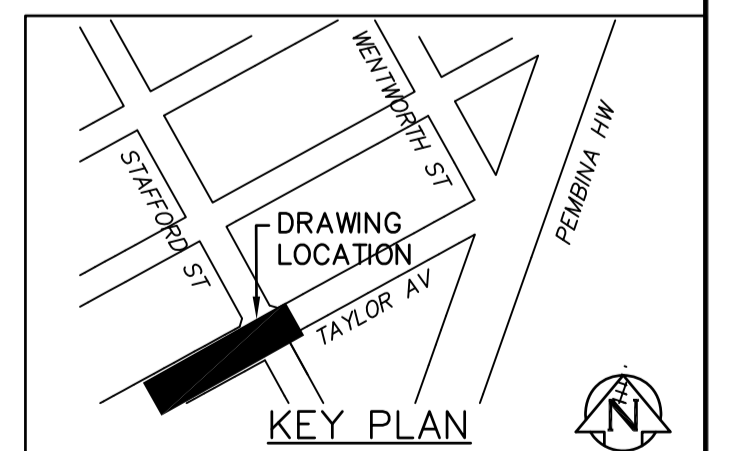

EXISTING	LEGEND-PLAN	PROPOSED	EXISTING	LEGEND-PLAN	PROPOSED	EXISTING	LEGEND-PROFILE	PROPOSED
150 WM	WATER MAIN	150 WM	HYDRO	M.T.S.	150 WM	WATER MAIN	150 WM	HYDRANT, VALVE
300 LDS	LAND DRAINAGE SEWER	300 LDS	CONCRETE	ASPHALT	300 LDS	LAND DRAINAGE SEWER	300 LDS	LAND DRAINAGE SEWER
250 WWS	WASTE WATER SEWER	250 WWS	SIDEWALK	PLANNING	250 WWS	WASTE WATER SEWER	250 WWS	WASTE WATER SEWER
MANHOLE	MANHOLE	MANHOLE	PROPERTY LINE	SURVEY BAR	MANHOLE	MANHOLE	MANHOLE	MANHOLE
CATCH BASIN	CATCH BASIN	CATCH BASIN	GAS	CURB STOP	CATCH BASIN	CATCH BASIN	CATCH BASIN	CATCH BASIN
CURB INLET	CURB INLET	CURB INLET	TEE	TEE	CURB INLET	CURB INLET	CURB INLET	CURB INLET
BEND	BEND	BEND			BEND	BEND	BEND	BEND
REDUCER	REDUCER	REDUCER			REDUCER	REDUCER	REDUCER	REDUCER

LOCATION APPROVED UNDERGROUND STRUCTURES
SUPV. U/G STRUCTURES COMMITTEE DATE
NOTE:
LOCATION OF UNDERGROUND STRUCTURES AS SHOWN ARE BASED ON THE BEST INFORMATION AVAILABLE BUT NO GUARANTEE IS GIVEN THAT ALL EXISTING UTILITIES ARE SHOWN OR THAT THE GIVEN LOCATIONS ARE EXACT. CONFIRMATION OF EXISTENCE AND EXACT LOCATION OF ALL SERVICES MUST BE OBTAINED FROM THE INDIVIDUAL UTILITIES BEFORE PROCEEDING WITH CONSTRUCTION.

NO.	REVISIONS	DATE	BY
1	ISSUED FOR ADDENDUM 3	02/2018	JBC
0	ISSUED FOR TENDER	01/2018	JBC

KGS GROUP CONSULTING ENGINEERS
DESIGNED BY SDG
DRAWN BY JBC
CHECKED BY MD
APPROVED BY RBO
HOR. SCALE: 1:250
VERTICAL: 1:50
RELEASED FOR CONSTRUCTION: K. ZUREK
DATE JAN 19, 2018

ENGINEER'S SEAL
ORIGINAL SIGNED BY M.R. DRAPER
JAN/19/2018
CONSULTANT DRAWING NO. C-250

THE CITY OF WINNIPEG WATER AND WASTE DEPARTMENT
PROJECT TITLE
COCKBURN AND CALROSSIE COMBINED SEWER RELIEF WORKS - CONTRACT 5
TAYLOR AVENUE
FROM STA 2+410 TO STA 2+530
SHEET OF 13 OF 25
COMPUTER FILE NAME C-250.dwg
CITY DRAWING NUMBER LD-8424